

# OPERATING MANUAL

## Luna LA325 - Sensor

Important: Please read the instruction manual carefully prior to installation and keep it for future reference.

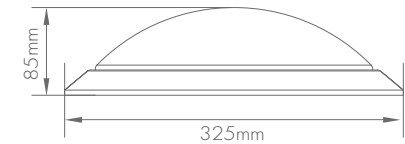

Ordering Code	Product Fitting Series	Power (W)	Function Description
LA325 18 SOF	Luna LA325	18	On/off function LED
LA325 18 SDM	Luna LA325	18	Sensor-Dim function LED
LA325 18 STM	Luna LA325	18	Corridor function (Tri-level dimming function) LED Fixture

Mounting: Wall or Ceiling

Light features:

Ra: >80

Life Time: 5 years

Light Source: LED SMD2835

Input: 220V-240V 50/60Hz

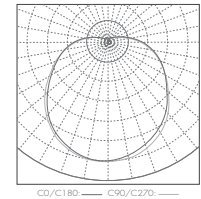

### Accessories

No.	Pic.	Qty.	Usage
1		3	Fitting base
2		3	Rawl plug

### Color Temperature Code

Code	Color temperature	CCT(K)	Lumen
30K	Warm White	3000	1450
40K	Natural White	4000	1510
50K	Cool White	5000	1590

### Installation

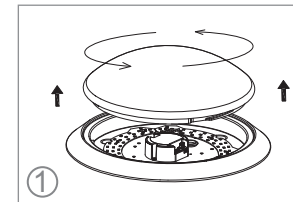

Twist the diffuser anticlockwise and vertically remove it.

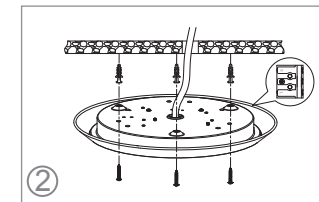

- Cut off the power. Thread the input cable through the rubber plug to the fixture. Connect the L, N, Earth wire based on the wiring diagram.
- Knock the rawl plugs into the pre-drilled holes on ceiling/wall. Wear plastic washers on self-tapping screws and tighten them to fix the fixture on ceiling/wall.

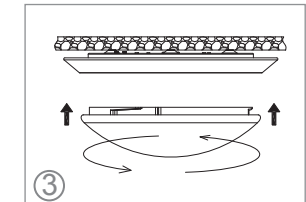

Install the diffuser.

## Wiring:

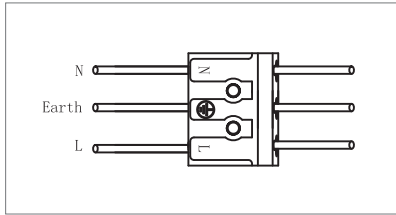

## Sensor On/off(dimming) Setting Options

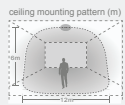

### Sensitivity

Sensitivity can be adjusted by selecting the combination on the DIP switches for different applications.

	1	
I	●	100%
II	○	50%

I – 100%  
II – 50%



### Hold-time

Hold-time refers to the time period that the light remains 100% on if no more movement is detected.

	2	3	
I	●	●	5s
II	●	○	90s
III	○	●	3min
IV	○	○	10min

I – 5s  
II – 90s  
III – 3min  
IV – 10min



### Daylight sensor

Different daylight threshold can be preset on DIP switches. Light will always turn on upon movement if daylight sensor is disabled.

	4	5	
I	●	●	Disable
II	●	○	50Lux
III	○	●	10Lux
IV	○	○	2Lux

I – Disable  
II – 50Lux  
III – 10Lux  
IV – 2Lux

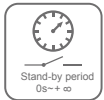

### Stand-by period

This is the time period that the light remains at a low level before it is completely turned off.

	6	7	
I	●	●	0s
II	●	○	10s
III	○	●	10min
IV	○	○	+∞

I – 0s  
II – 10s  
III – 10min  
IV – +∞



### Stand-by dimming level

Light can be dimmed to different levels after hold-time.

	8	
I	●	10%
II	○	30%

I – 10%  
II – 30%

## Detection Pattern

ceiling mounting pattern (m) wall mounting pattern (m)

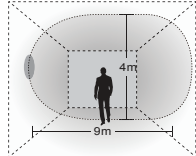
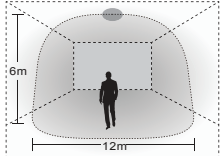

## Maintenance

1. Cut off the main power first
2. Don't touch LEDs while maintaining or cleaning
3. Don't use chemicals to clean the fixture.

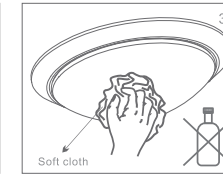
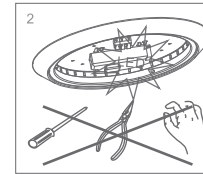
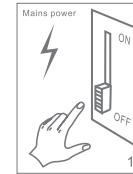

Environmental protection: waste electrical products should not be disposed of with household waste. Please recycle where facilities exist. Check with your local authority or retailer for recycling advice.

## Caution

1. The product must be installed by professional technicians and the power supply must be cut off before installation.
2. The installation wiring must be at least 0.75mm<sup>2</sup> and wired in accordance with the latest IEE electrical regulations or the national requirements.
3. Do not touch the electronic circuit and its components.
4. Contact an authorised technical service centre for any repairs required and use only original spare parts.
5. Do not touch LEDs while installing or maintaining.
6. The LED light source can not be replaced.

