

OPERATING MANUAL

Quanta Q290 - Basic

Important: Please read the instruction manual carefully prior to installation and keep it for future reference.

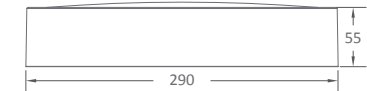

Ordering Code	Product	Power (W)	Function Description
	Fitting Series		
Q290 18 000	Q290	18	Basic LED Fixture

Mounting: Wall or Ceiling

Light features:

Ra: >80

Life Time: 5 years

Light Source: LED SMD2835

Input: 220V-240V 50/60Hz

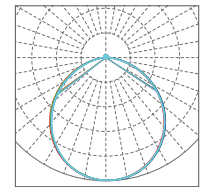

— C0/180,110.1 — C60/240,109.5
— C30/210,110.5 — C90/270,108.9

Accessories

No.	Pic.	Qty.	Usage
1		3	Fix light
2		3	Rawl plug
3		1	Vandal proof screw tool
4		3	Plastic washer
5		2	Fix cable clip
6		1	Cable clip
7		1	Cable clip
8		4	Plastic plug

Colour Temperature Code

Code	Colour Temperature	CCT(K)	Lumen
30K	Warm White	3000	2016
40K	Natural White	4000	2160
50K	Cool White	5000	2196

Installation

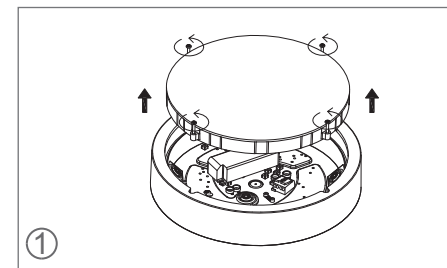

Unscrew the diffuser anticlockwise.
Vertically remove the diffuser and PCBA.

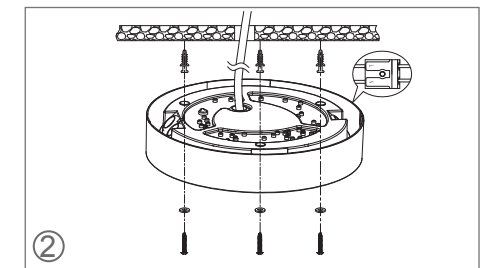

- Cut off the power. Thread the input cable through the rubber plug to the fixture. Connect the L, N wire referring to the wiring diagram.
- Knock the rawl plugs into the pre-drilled holes on ceiling /wall. Wear plastic washers on self-tapping screws and tighten them to fix the fixture on ceiling/wall.

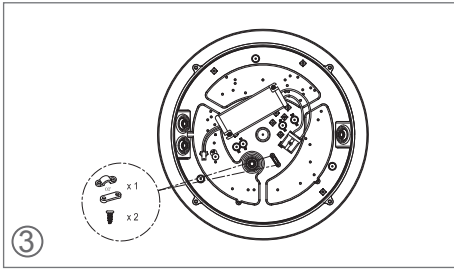

③ Install the cable clip.

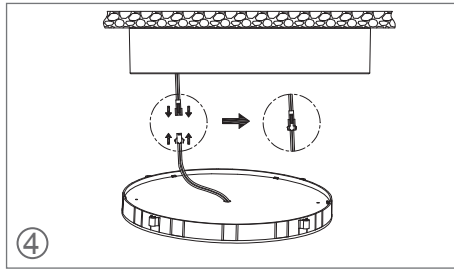

④ Connect the DC cable.

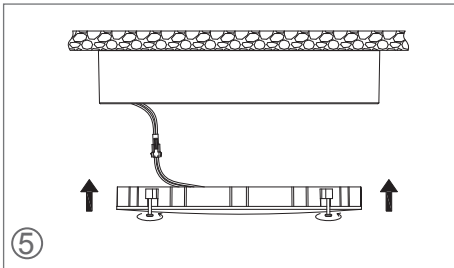

⑤ Mount the diffuser onto the base with screws.

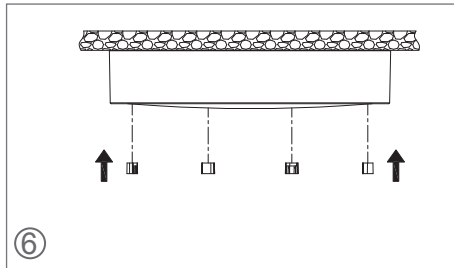

⑥ Install the plastic plugs to hide the screws.

Wiring

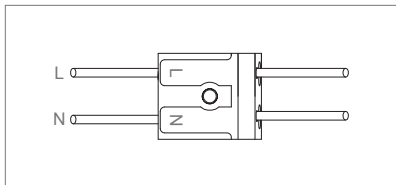

Maintenance

1. Cut off the main power first.
2. Don't touch LEDs while maintaining or cleaning.
3. Don't use chemicals to clean the fixture.

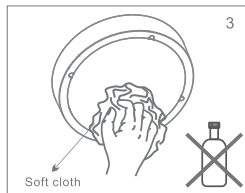
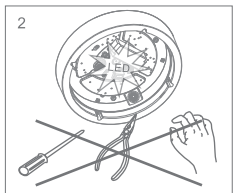
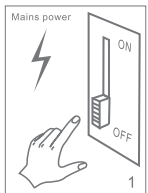

Environmental protection: waste electrical products should not be disposed of with household waste. Please recycle where facilities exist. Check with your local authority or retailer for recycling advice.



Caution

1. The product must be installed by professional technicians and power supply must be cut off before installation.
2. The diameter for AC input wire is 0.75mm² (complying with 60245 IEC57), which complies with the latest IEE electrical standards or national standards.
3. Do not touch the electronic circuit and its components.
4. Contact an authorised technical service centre for any repairs possibly required use only original spare parts.
5. Do not touch LED while installing or maintaining.
6. Sealing the entrance hole with glue after install is needed.
7. The light source contained in this luminaire shall only be replaced by the manufacturer or his service agent or a similar qualified person.

